

PAKO-E464U

4U Rackmount Chassis, Industrial Main Board Support

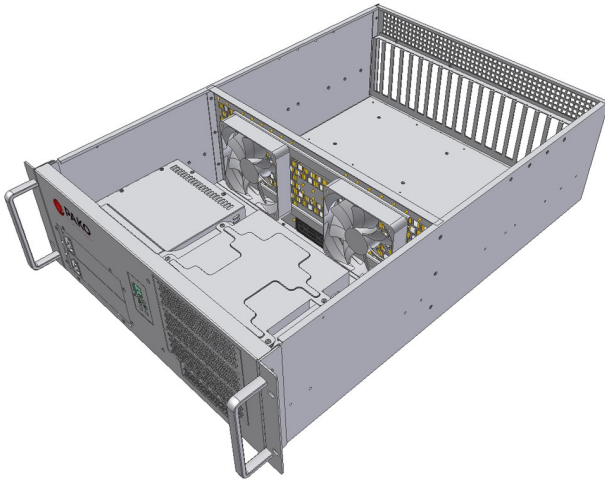
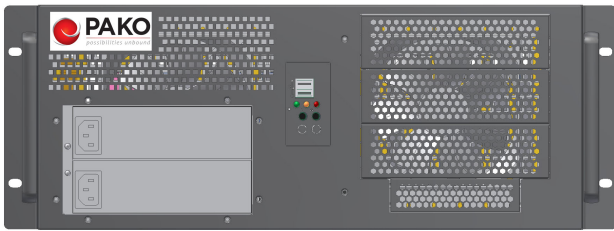
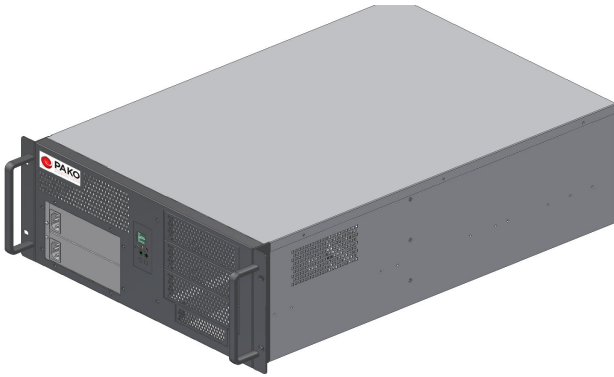

Features

- 4U Height 19" Rackmount Chassis
- Standard Motherboard ATX, Micro ATX Form Factors
- 5.25" x 3 and 3.5" x 2 Front Accessible Disk Drive Bays
- Internal 3.5" Disk Drive Bay For Hard Disk x 1
- Lockable Door For Protecting The Running System
- USB Port x 2 and Keyboard Connector x 1 On Front Panel



Specifications

System	
Construction	Heavy-duty Steel
Storage	Internal: 3.5" Drive Bay x 2 5.25" Drive Bay x 3
System Fan	12 cm Ball Bearing Fan with Removable Filter x 1
Front Panel	Power ON/OFF Switch x 1 Keyboard Lock Switch x 1 Reset Button x 1 Power ON LED x 1 Hard Disk Drive Active LED x 1 USB Port x 2 PS/2 Keyboard Connector x 1
Rear Panel	AT Keyboard Connector x 1 Reserved Cut-out for DB-25 Connector x 1
Color	Scratch-resistant Black Textured
Dimensions	19.03" (W) x 25.58" (D) x 6.97" (H) (483.50mm x 649.80mm x 177.20mm)
Net Weight	28.1 lb (12.75 kg)
Gross Weight	34.7 lb (15.76 kg)
Environmental	
Operating Temperature	32°F ~ 122°F (0°C ~ 50°C)
Storage Temperature	-4°F ~ 176°F (-20°C ~ 80°C)
Operating Humidity	10 ~ 90%
Storage Humidity	10 ~ 90% @ 40°C, non-condensing
Vibration	0.5 g rms/ 5 ~ 500 Hz/ operation (2.5" Hard Disk Drive) 1.5 g rms/ 5 ~ 500 Hz/ non operation
Shock	15 G peak acceleration (11 m sec. duration), operation 30 G peak acceleration (11 m sec. duration), non operation
EMC	CE/FCC Class A

PAKO-E464U

Dimension Unit: mm

